

MOTTI



ASL SCENARIO RH4

Scenario Design: Rhett Richwell & Hannu Tuikkala



East of Lemetti, FINLAND, 28 December 1939: The Winter War had lasted for nearly a month. After the initial shock the Finns soon developed a tactic that would later be known as the motti. It demanded highly motivated soldiers who could move swiftly by ski behind enemy lines and were used to the harsh winter conditions. The Russians advanced mostly along the few roads in long columns. That meant that they were stretched out and poorly able to defend themselves. North of Lake Ladoga the Russian 168th Infantry Division was advancing along the Salmi-Kitelä road while the 18th Infantry Division and the 34th Tank Brigade advanced along the Käsnäselkä-Lemetti-Kitelä road. On December 27th Finnish detachment *Tykkä* reached an area east of Lemetti and made a surprise attack on rear elements of the 18th. One of the Finnish battalions (I/JR 36) reached the road while the other was stopped about 200 meters north of it. I/JR 36 was then ordered to withdraw. Next day they attacked again.

BOARD CONFIGURATION:

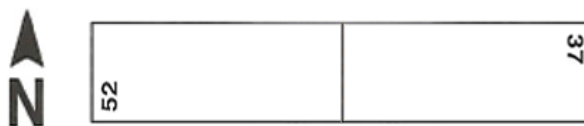

VICTORY CONDITIONS: The Finns win at the end of any Game Turn if twelve plus a random number (see SSR 3) of consecutive vertical hexrows are free of Good Order Russian MMC and Mobile AFV (D.7) and has at least one Good Order Finnish MMC.

BALANCE: ★ The number of Finnish 5-4-8 is 2, not 2 + ?.
 🇫🇮 Remove the Russian T-26S M37.

TURN RECORD CHART

★ RUSSIAN Sets Up First [103]	1	2	3	4	5	6	7	END
🇫🇮 FINN Moves First [103 + ? x 14]								

★ **Elements of 1st Battalion, 97th Regiment, 18th Infantry Division and part of its armored attachment [ELR: 2]** set up anywhere along the plowed road according to the restrictions of SSR 2: {SAN: 2}

9 10 3 2 5 4

🇫🇮 **Elements of 1st and 3rd Companies, 1st Battalion, Infantry Regiment 36 [ELR: 4]** set up HIP in Concealment Terrain anywhere north of and not adjacent to the plowed road on/between hexrows 52K and 37K: {SAN: 4}

5 2+? 3 3

SSR 3

SPECIAL RULES:

- EC is Snow, with no wind at start. Deep Snow (E3.73) [EXC: Only Finnish units have Winter Camouflage] and Extreme Winter (E3.74) are in effect. The road 52A5-52GG5-37X5-37P5-37H4-37A6 is Plowed (E3.724).
- At setup all trucks must contain at least one MMC as Passengers. SMC start in trucks. All SW must be possessed by MMC in trucks. All vehicles set up in Motion facing west.
- The number of extra Finnish 5-4-8 at start is not known to the Russian player and can be from 3 to 6. Before setup the Finnish player draws a chit from a pile marked 3 to 6. This is the number of extra 5-4-8 beyond two he gets. It is also the number of additional consecutive vertical hexrows beyond twelve in the Victory Conditions. The drawn chit is not revealed to the Russian player until the game is over.
- Finnish units have MOL capability (A22.6).
- The Finns have the option of using one *felled tree*. A felled tree is like a Roadblock (B29) except that it is considered a Hedge, not a stone wall. A felled tree is placed in any

plowed road hex by a Good Order Finnish squad being in that hex at the start of their Player Turn, going TI, and if still TI and in Good Order at the end of the CCPh, placing a Roadblock counter in that hex and removing TI. Failure to place is considered use of the option and can not be retried. A felled tree can be cleared by both sides (B24.76).

AFTERMATH: The I/JR 36 and II/JR 36 made a successful attack and managed block the road. As it turned out the road was now permanently blocked. Instead of supporting its forward division, the 18th Infantry Division and 34th Tank Brigade soon found themselves isolated in a number of mottis and were gradually reduced. The bulk of the 168th Infantry Division was surrounded near Kitelä and did little more than survive until the end of the war. Those who escaped the mottis were lucky if they were caught by the Finns. The rest perished one by one in the deep snow and cold. As usual it was the common soldier who had to pay the price for their leaders' folly.